



R341 CU1  
R341 CU2

Leaders in twisting technology since 1869

RATTI TWISTING MACHINERY  
TECHNICAL YARNS



made in *Italy*

# TWISTER FOR THE PROCESSING OF HEAVY INDUSTRIAL SEWING THREADS

## R341 CU 1/ R341 CU 2: twisters for the first and second step of sewing thread process.

- Two-for-one twisters for heavy/industrial sewing threads of synthetic and artificial yarns.
- Processing of 2, 3, 4 plies sewing threads.
- The large supply package and the high counts need a sturdy machine frame, two-for-one spindles easily accessible by the operators as well as a suitable take-up cradle.
- The spindles are fitted on a swing arm allowing their disengagement from the belt, toward the operator, so easing both the loading/doffing of the machine and its maintenance
- In the first step (R341 CU1) each spindle is equipped with sensor and yarn cutter.
- In case of breakage of one of the plies under assembly-twisting, the sensor immediately detects its absence and promptly commands the cut of the other plies (1, 2 or 3) under processing in that specific position, meanwhile activating a signal light. At the same time, a pneumatic system disengages from the belt the spindle where the yarn breakage occurred.
- A selector switch allows to pre-set the sensors and cutters working scheme, according to the plies under processing (2, 3 or 4), while a centralized meter counter allows the formation of metered packages.
- The ceramic overfeeders assure the evenness of the take-up tension of each single ply under assembly-twisting in the first step (R341 CU1) as well as the tension of the final thread under twisting in the second step (R341 CU2).
- The first step machine (R341 CU 1) can fit spindles type NT-260, NT-280 or NT280/305, NT280/310, NT280/330, for a range of counts between 167 Dtex and 1700 Dtex and on supply packages from 250 to 315 mm diameter, depending on the spindle.
- The second step machine (R341 CU 2) is provided with spindles type NT-220, equipped with pots and suitable flyers to unwind the yarn (wound onto flanged bobbins) proceeding from the first step machine.
- Inverterised spindles driving motor (for both machines models).
- Touch screen control panel for the monitoring of: spindles speed, take-up speed, yarn meter counter, alarm displaying, working hours, maintenance program memo, settings of S and Z twist direction.
- Machine built according to the last CE standards for quality and safety.

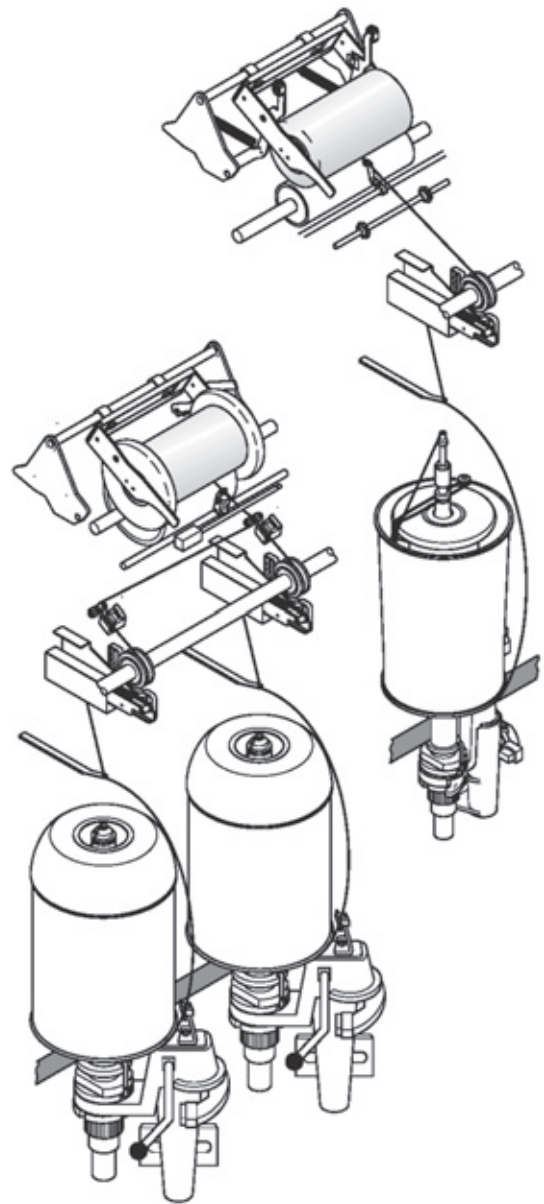

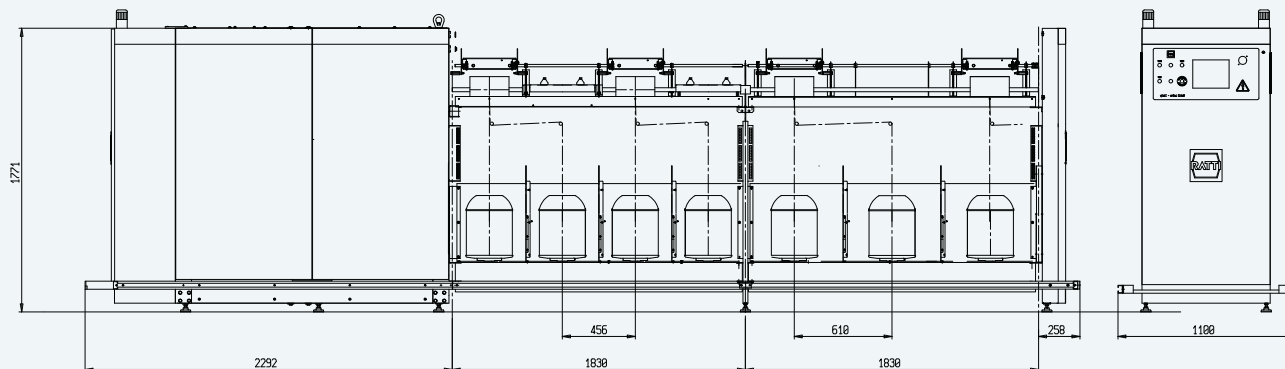

Number of sections	1	2	3	4	5	6	7	8	9	nr
Number of spindles	8/6	16/12	24/18	32/24	40/30	48/36	56/42	64/48	72/54	nr
Machine length	4380	6210	8040	9870	11.700	13.530	15.360	17.190	19.020	mm

## MACHINE MODEL R341 CU 1: TECHNICAL DATA

### SPINDLES

Spindle type	NT260	NT280	NT280/305	NT280/310	NT280/330	
Gauge	456 or 610					mm
Max. technological speed	7.000	6.000	6.000	6.000	6.000	rpm
Whorl diameter	64					mm
Twist range	60-470					TPM
Count range	167-1700	334-1700	334-1700	334-1700	550-1700	Dtex

### SUPPLY PACKAGE

Type	bobbin					
Diameter max.	250	270	290	295	315	mm
Length max.	290					mm
Capacity	10.000	12.000	15.000	17.000	17.000	grams

### TAKE-UP

Number of decks	1	nr
Take-up per section	4	nr
Max. number of take-up	36	nr
Gearbox	UD	
Number of plies	2, 3, 4	nr
Take-up type	flanged bobbin	
Diameter max.	210	mm
Traverse	250	mm
Max. technological speed	50	m/min

### FRAME

Max. number of section	9	nr
Section length	1830	mm
Max. machine length	19020	mm
Machine width	1100	mm
Machine height	1850	mm
Height of take-up	1414	mm
Max. installed motor power	30	kW
Max. weight, approx	6920	kg

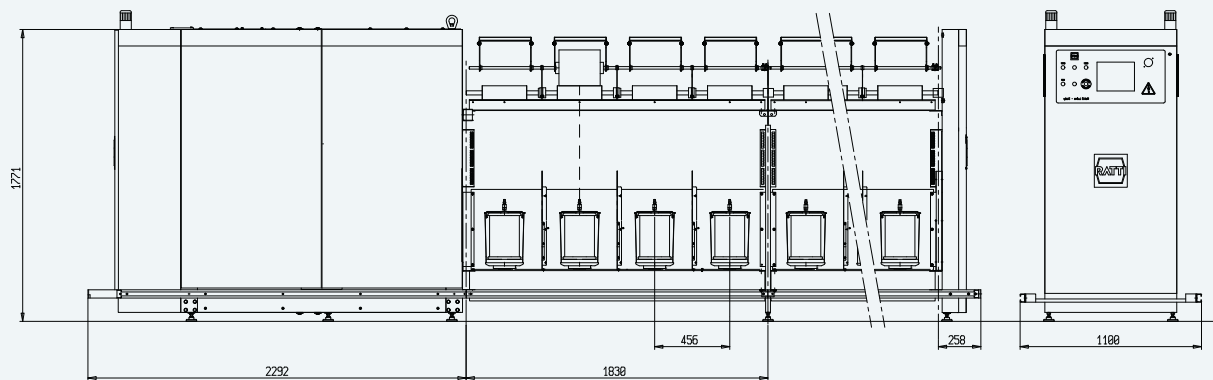

Number of sections	1	2	3	4	5	6	7	8	9	10	nr
Number of spindles	8	16	24	32	40	48	56	64	72	80	nr
Machine length	4380	6210	8040	9870	11.700	13.530	15.360	17.190	19.020	20.850	mm

## MACHINE MODEL R341 CU 2: TECHNICAL DATA

### SPINDLES

Spindle type	NT220	
Gauge	456	mm
Max. technological speed	8.000	rpm
Whorl diameter	64	mm
Twist range	60-899	TPM
Count range	330-5500	Dtex

### SUPPLY PACKAGE

Type	Flanged bobbin	
Diameter max.	210	mm
Length max.	250	mm
Capacity	6.000	grams

### TAKE-UP

Number of decks	1	nr
Take-up per section	8	nr
Max. number of take-up	80	nr
Gearbox	UDR	
Take-up type	biconical bobbin	
Diameter max.	250	mm
Tube dimensions (Dia x L)	69x290	mm
Traverse	250	mm
Max. technological speed	170	m/min

### FRAME

Max. number of section	10	nr
Section length	1830	mm
Max. machine length	20850	mm
Machine width	1100	mm
Machine height	1850	mm
Height of take-up	1414	mm
Max. installed motor power	30	kW
Max. weight, approx	6920	kg

## FLOW CHART OF SEWING THREAD PROCESS

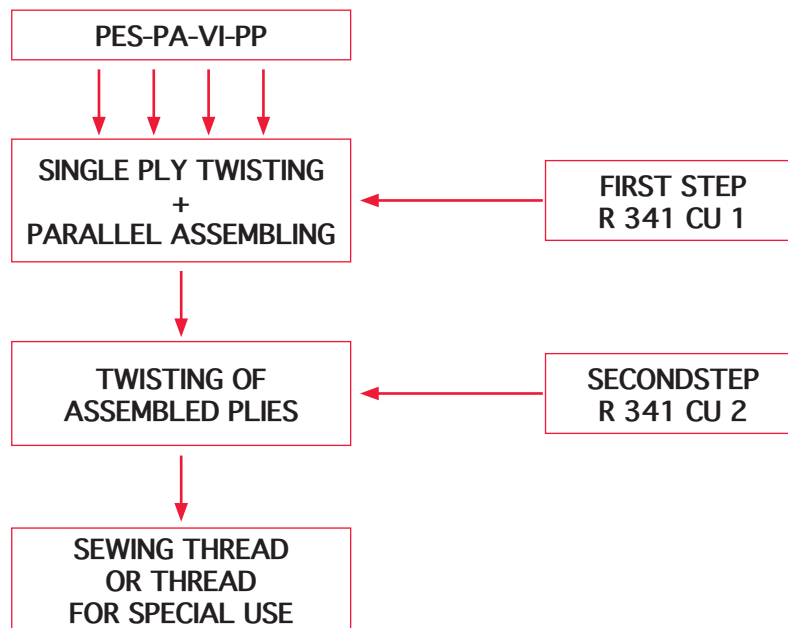

### OPTIONALS

- ELECTRONIC SETTING OF THE TPM LEVEL
- INVERTERISED OVERFEEDER DRIVING
- TAKE-UP CRADLE FOR SOFT PACKAGES (CU2)
- REMOTE ASSISTANCE
- MACHINE LINKING TO COMPANY NETWORK
- POSSIBILITY TO PERSONALISE THE MACHINE, ACCORDING TO THE CUSTOMER REQUIREMENTS

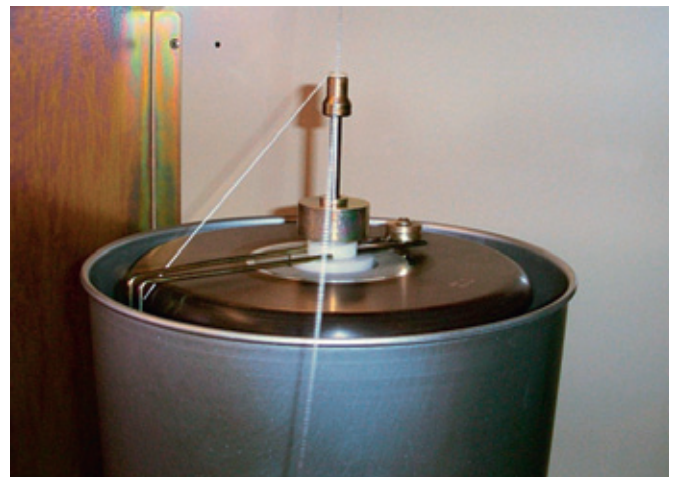



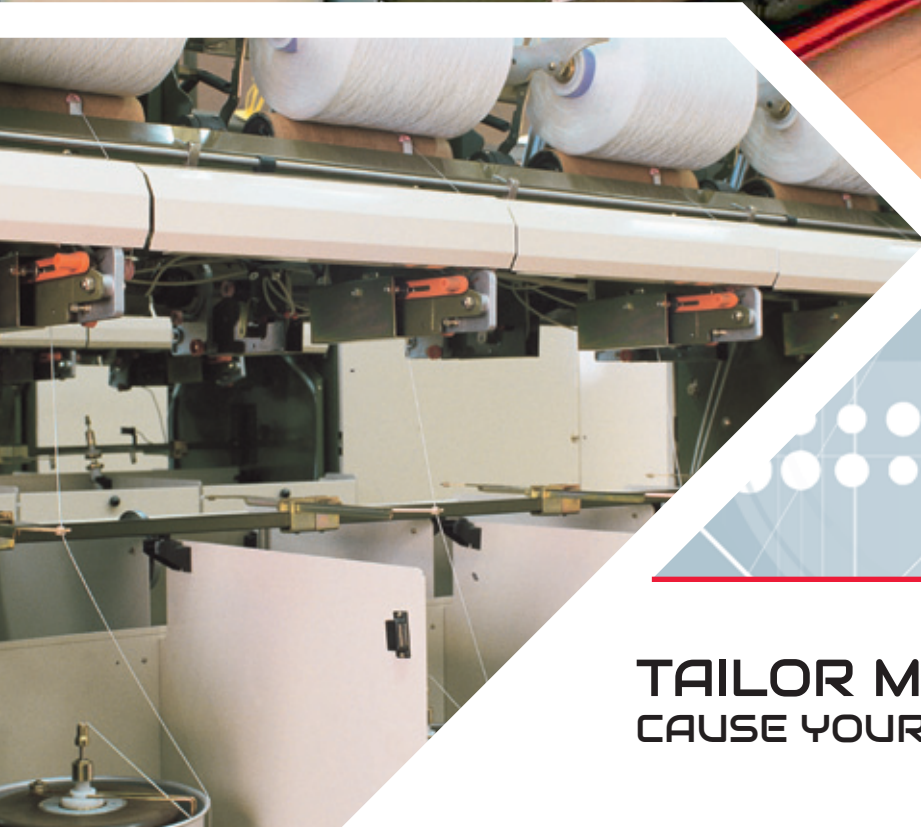

**TAILOR MADE MACHINES  
CAUSE YOUR NEEDS IS OUR JOB!**



**RATTI Luino S.r.l.**

Via Provinciale, 309 - 21030 Cassano Valcuva (VA) - Italy  
Phone: +39 0332 538.411 - Fax +39 0332 530.988  
[info@rattiluino.com](mailto:info@rattiluino.com) - [www.rattiluino.com](http://www.rattiluino.com)

